

Soils Map

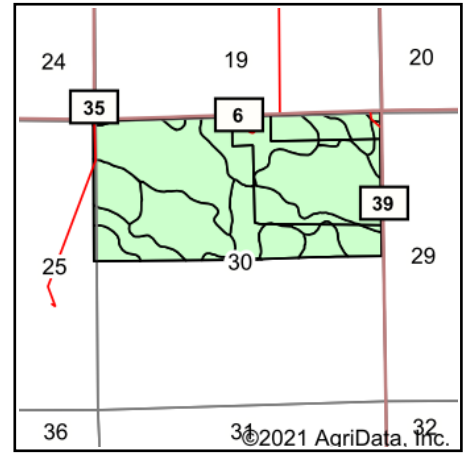
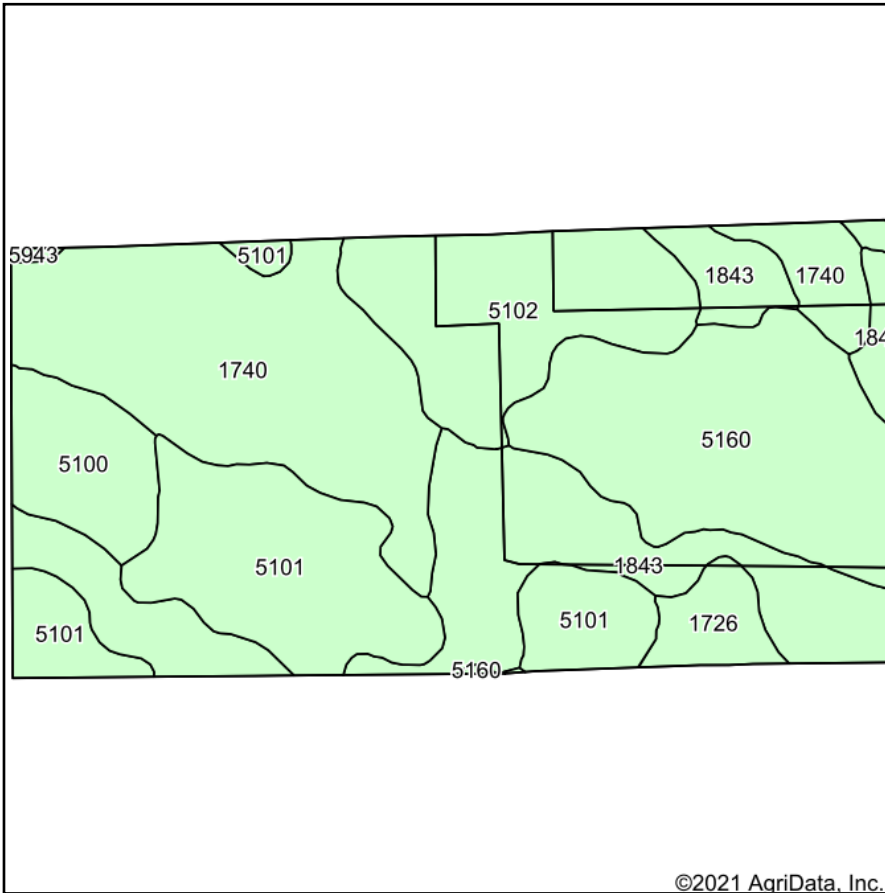

State: **Nebraska**
 County: **Banner**
 Location: **30-17N-55W**
 Township: **Long Springs**
 Acres: **319.58**
 Date: **1/29/2021**

KRAUPIE'S
 REAL ESTATE & AUCTIONEERS
 farmauction.net
 915 Main St • Bridgeport, NE 69336 • 308-262-1150

Maps Provided By:

 CUSTOMIZED ONLINE MAPPING
 © AgriData, Inc. 2020 www.AgriDataInc.com



Soils data provided by USDA and NRCS.

| Area Symbol: NE007. Soil Area Version: 26 | | | | | | | | | | | | |
|---|---|-------|------------------|------------------|--------------|--------------------------------|-------------|----------------|---------------------|--------------|------------------------|-------------------|
| Code | Soil Description | Acres | Percent of field | Non-Irr Class *c | Irr Class *c | Range Production (lbs/acre/yr) | SRPG | Corn Irrigated | Dry beans Irrigated | Winter wheat | Winter wheat Irrigated | *n NCCPI Soybeans |
| 1740 | Rosebud-Canyon loams, 3 to 6 percent slopes | 74.02 | 23.2% | IIIe | IIIe | 1260 | 20 | 112 | 26 | 26 | | 26 |
| 1843 | Sidney-Canyon loams, 6 to 9 percent slopes, eroded | 65.17 | 20.4% | IVe | IVe | 1140 | 27 | 95 | 26 | 20 | | 17 |
| 5160 | Canyon-Sidney loams, 9 to 20 percent slopes, eroded | 57.66 | 18.0% | VI s | | 1020 | 18 | | | | | 12 |
| 5101 | Alliance loam, 1 to 3 percent slopes | 57.14 | 17.9% | IIIe | Ile | 1297 | 56 | 140 | 36 | 38 | | 35 |
| 5102 | Alliance loam, 3 to 6 percent slopes | 39.57 | 12.4% | IIIe | IIIe | 1700 | 54 | 125 | 34 | 34 | | 34 |
| 5100 | Alliance loam, 0 to 1 percent slopes | 17.33 | 5.4% | IIIc | Iw | 1297 | 58 | 144 | 40 | 40 | | 35 |
| 1726 | Rosebud loam, 1 to 3 percent slopes | 8.20 | 2.6% | IIIe | IIIe | 1703 | 31 | 124 | 32 | 28 | 62 | 38 |
| 5943 | Duroc loam, 1 to 3 percent slopes | 0.49 | 0.2% | IIIe | Ile | 1693 | 52 | 140 | 38 | 39 | | 30 |
| Weighted Average | | | | | | 1267.4 | 34.1 | 97 | 25 | 24.1 | 1.6 | *n 25 |

*n: The aggregation method is "Weighted Average using all components"

*c: Using Capabilities Class Dominant Condition Aggregation Method

Soils data provided by USDA and NRCS.