

# Soils Map

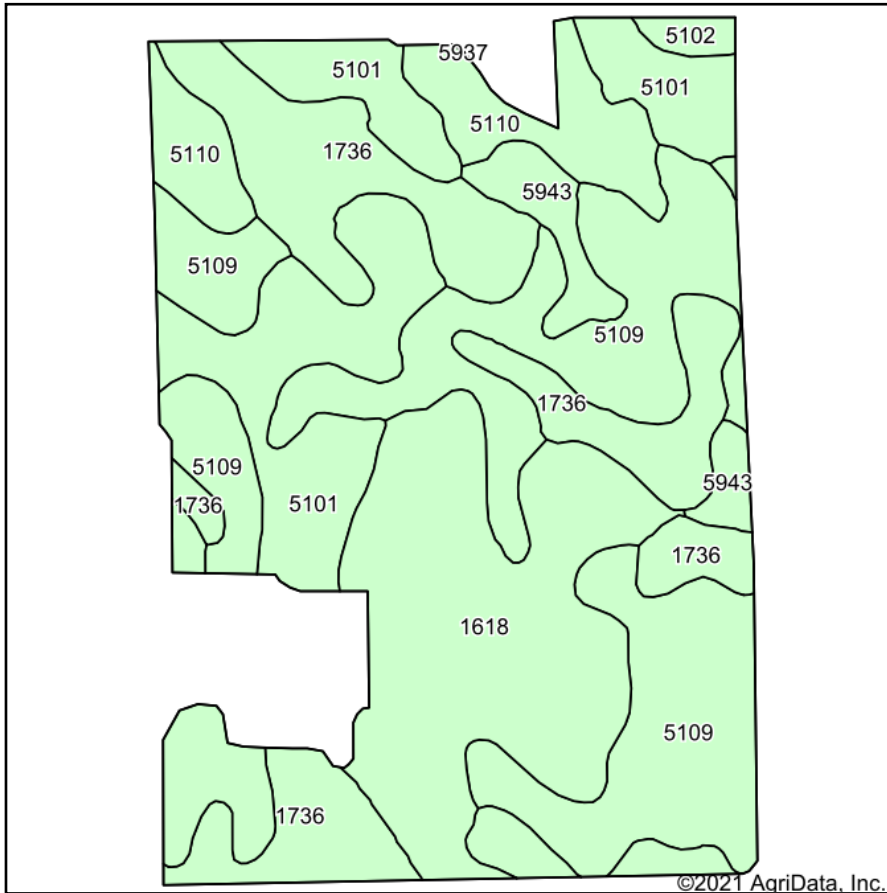

Soils data provided by USDA and NRCS.

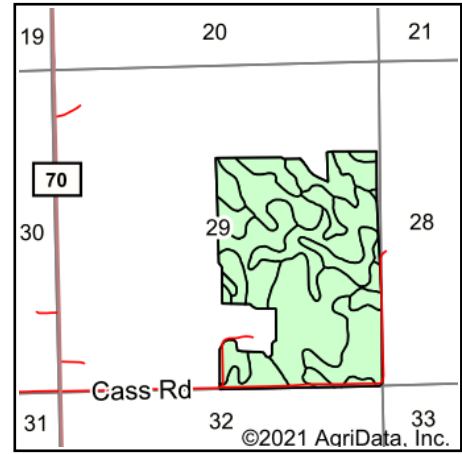

State: **Nebraska**  
 County: **Box Butte**  
 Location: **29-28N-49W**  
 Township: **Dorsey**  
 Acres: **213.29**  
 Date: **2/3/2021**



915 Main St • Bridgeport, NE 69336 • 308-262-1150

Maps Provided By:



© AgriData, Inc. 2021

www.AgriDataInc.com



Code	Soil Description	Acres	Percent of field	Non-Irr Class *c	Irr Class *c	Range Production (lbs/acre/yr)	SRPG	Corn Irrigated	Dry beans Irrigated	Sugar beets Irrigated	Winter wheat	*n NCCPI Soybeans
5109	Alliance-Rosebud loams, 3 to 6 percent slopes	60.88	28.5%	IIIe	IIIe	2045	44	111	28	17	32	40
1618	Keith loam, 1 to 3 percent slopes	44.58	20.9%	Ile	Ile	1799	63	134				55
1736	Rosebud-Canyon complex, 3 to 9 percent slopes	43.65	20.5%	IVe	IVe	1783	20	104	25	16	28	27
5101	Alliance loam, 1 to 3 percent slopes	40.94	19.2%	Ile	Ile	2411	58	140	30	19	34	42
5110	Alliance-Rosebud loams, 6 to 11 percent slopes	14.66	6.9%	IVe	IVe	2092	40				27	38
5943	Duroc loam, 1 to 3 percent slopes	7.02	3.3%	IIc		1342	55				32	44
5102	Alliance loam, 3 to 6 percent slopes	1.56	0.7%	IIIe	IIIe	2395	56	128	26	16	30	41
<b>Weighted Average</b>						<b>1992.9</b>	<b>45.9</b>	<b>108.8</b>	<b>19.1</b>	<b>11.9</b>	<b>24.5</b>	<b>*n 40.9</b>

\*n: The aggregation method is "Weighted Average using all components"

\*c: Using Capabilities Class Dominant Condition Aggregation Method

Soils data provided by USDA and NRCS.